

UE G10.1
Collado Villalba
Estudio acustico
Mapa 1 - Situacion

Collado-Villalba

Estación ff.cc.

UE G10.1

Ferrocarril

A-6



500 0 500 metros

Escala 1:10.000
Coordenada UTM 30 N
Elipsoide Hayford

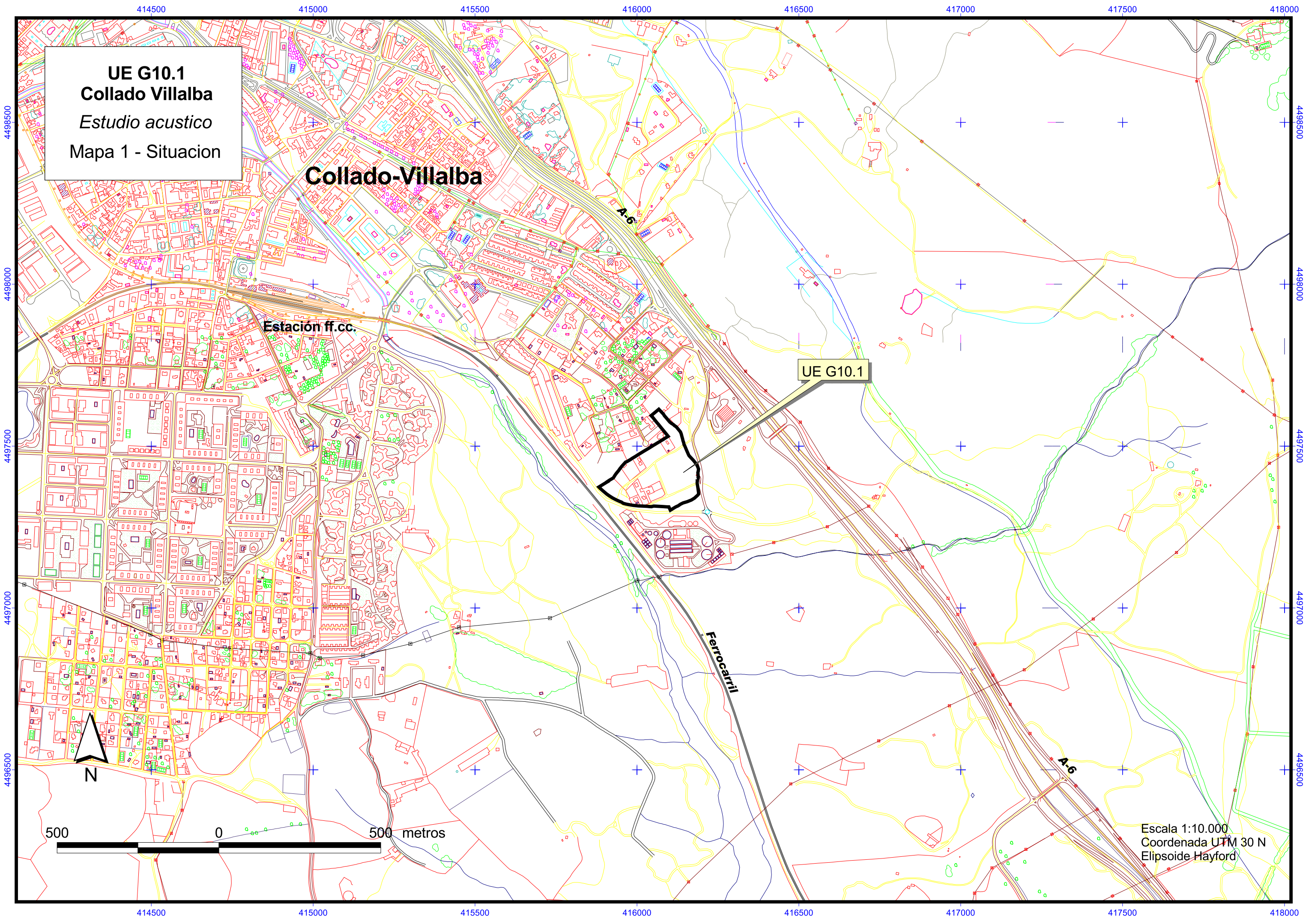

415800

415900

416000

416100

416200

416300

UE G10.1
Collado Villalba
Estudio acustico
Mapa 2 - Usos

4497600

4497600

4497500

4497500





4497400

4497400

4497300

4497300

Usos

-  Servicios
-  Res. unifamiliar
-  Zona verde
-  Viario



50 0 50 100 metros



Escala 1:1.500
 Coordenada UTM 30 N
 Elipsoide Hayford

415800

415900

416000

416100

416200

416300

415800

415900

416000

416100

416200

416300

UE G10.1
Collado Villalba
Estudio acustico
Mapa 3 - Zonificacion acustica

4497600

4497600

4497500

4497500

4497400





4497400

4497300

4497300

 Punto de medida

Zonificacion acustica

-  Tipo II
-  Tipo III
-  Tipo II (verde)
-  Viario

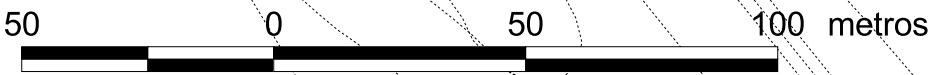

Escala 1:1.500
 Coordenada UTM 30 N
 Elipsoide Hayford

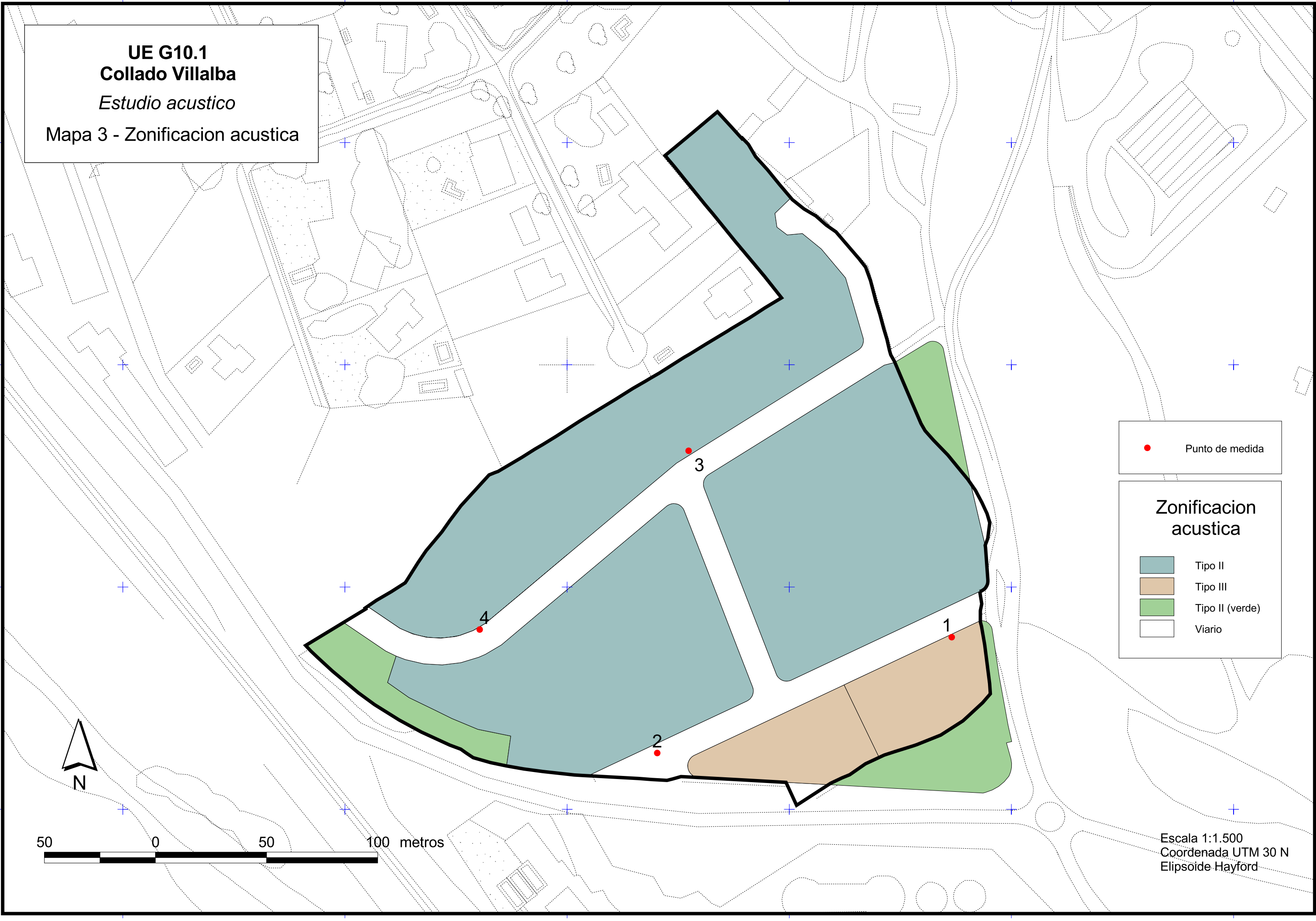

415800

415900

416000

416100

416200

416300

UE G10.1
Collado Villalba
Estudio acustico
Mapa 4 - Situacion 2009/dia

4497600

4497600

4497500

4497500

4497400

4497400

4497300

4497300

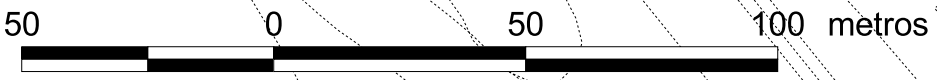
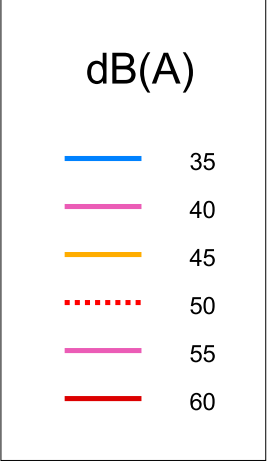

Escala 1:1.500
 Coordenada UTM 30 N
 Elipsoide Hayford

415800

415900

416000

416100

416200

416300

415800 415900 416000 416100 416200 416300

UE G10.1
Collado Villalba
Estudio acustico
Mapa 5 - Situacion 2009/noche

4497600
4497500
4497400
4497300

4497600
4497500
4497400
4497300

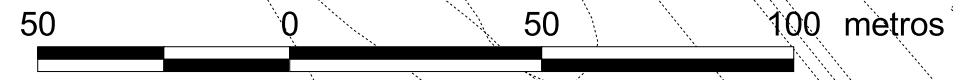
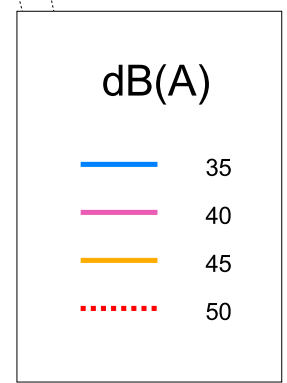

Escala 1:1.500
Coordenada UTM 30 N
Elipsoide Hayford

415800 415900 416000 416100 416200 416300

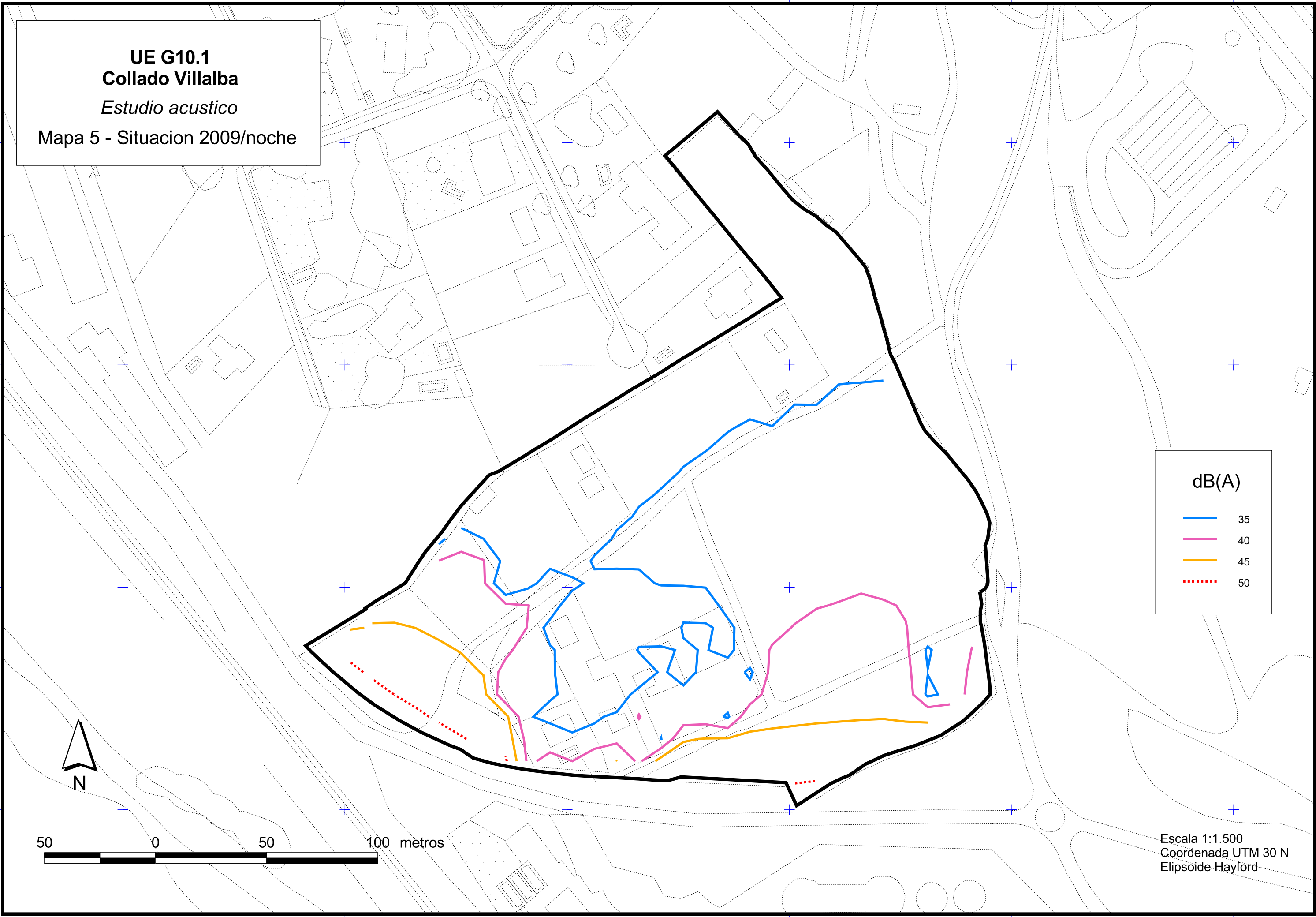

415800

415900

416000

416100

416200

416300

UE G10.1
Collado Villalba
Estudio acustico
Mapa 6 - Situacion 2011/dia
- 1,5 m -

4497600

4497500

4497400

4497300

4497600

4497500

4497400

4497300

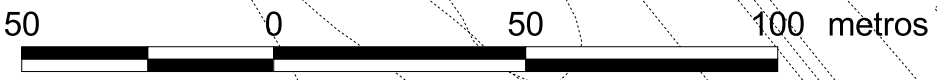
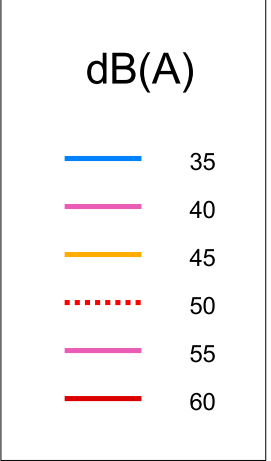

Escala 1:1.500
 Coordenada UTM 30 N
 Elipsoide Hayford

415800

415900

416000

416100

416200

416300

415800

415900

416000

416100

416200

416300

UE G10.1
Collado Villalba
Estudio acustico
Mapa 7 - Situacion 2011/noche
- 1,5 m -

4497600

4497500

4497400

4497300

4497600

4497500

4497400

4497300

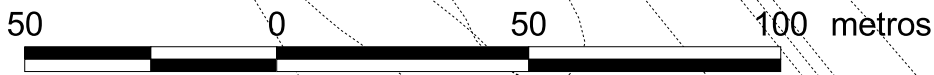
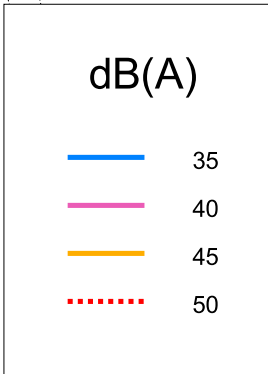

Escala 1:1.500
 Coordenada UTM 30 N
 Elipsoide Hayford

415800

415900

416000

416100

416200

416300

UE G10.1
Collado Villalba
Estudio acustico
Mapa 8 - Situacion 2011/dia
- 4 m -

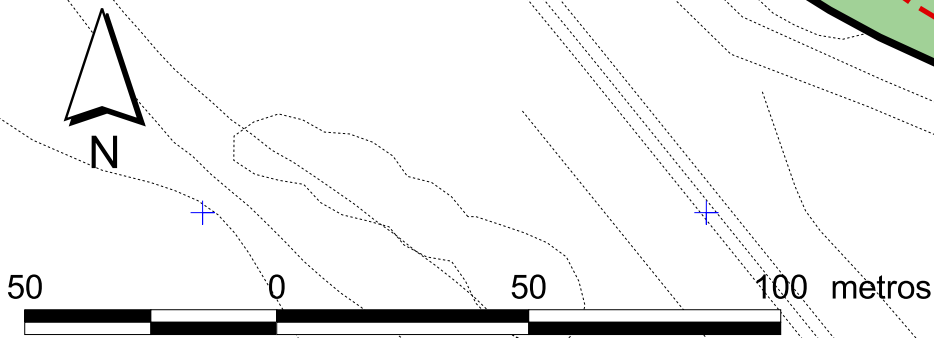
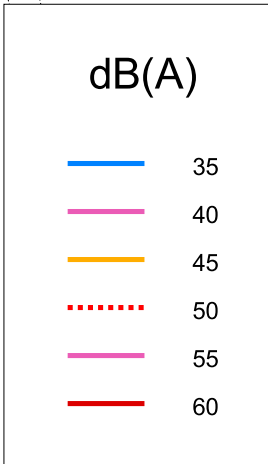

Escala 1:1.500
Coordenada UTM 30 N
Elipsoide Hayford

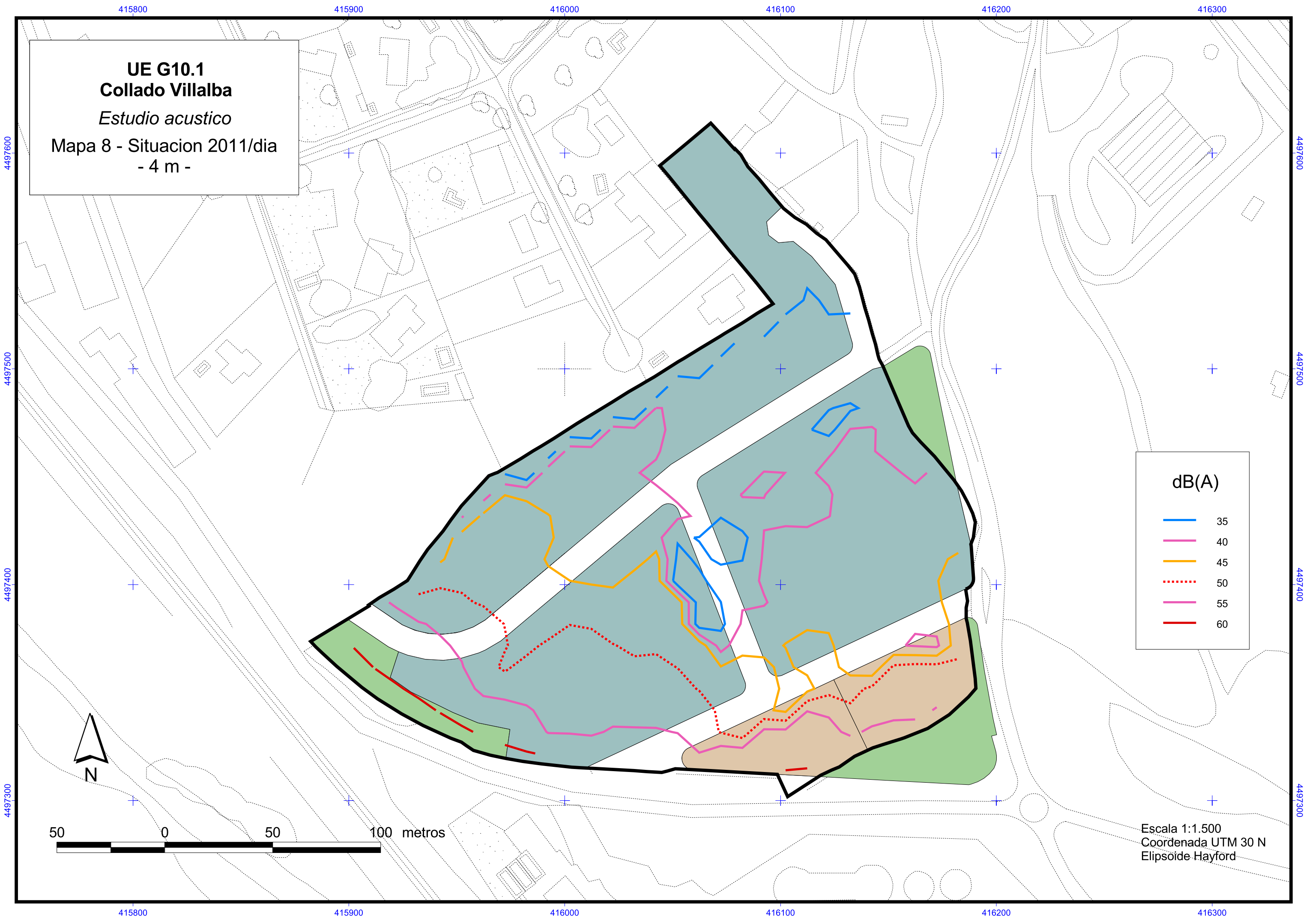

415800

415900

416000

416100

416200

416300

UE G10.1
Collado Villalba
Estudio acustico
Mapa 9 - Situacion 2011/noche
- 4 m -

4497600

4497500

4497400

4497300

4497600

4497500

4497400

4497300

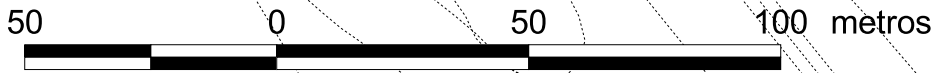
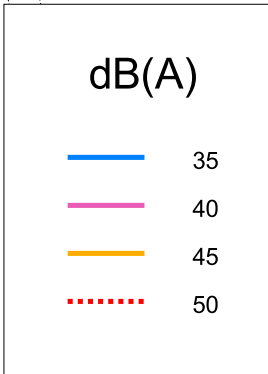

Escala 1:1.500
 Coordenada UTM 30 N
 Elipsoide Hayford

415800

415900

416000

416100

416200

416300

415800

415900

416000

416100

416200

416300

UE G10.1
Collado Villalba
Estudio acustico
Mapa 10 - Situacion 2011/dia
- 7 m -

4497600

4497500

4497400

4497300

4497600

4497500

4497400

4497300

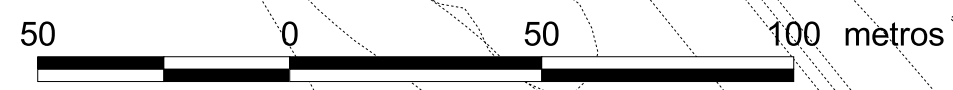
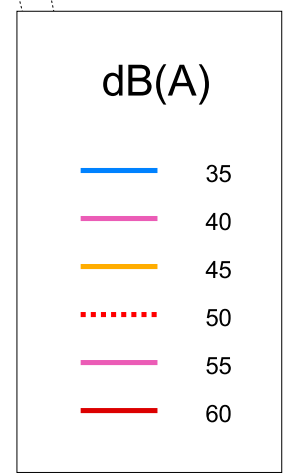

Escala 1:1.500
 Coordenada UTM 30 N
 Elipsoide Hayford



415800

415900

416000

416100

416200

416300

415800

415900

416000

416100

416200

416300

UE G10.1
Collado Villalba
Estudio acustico
 Mapa 11 - Situacion 2011/noche
 - 7 m -

4497600

4497500

4497400

4497300

4497600

4497500

4497400

4497300

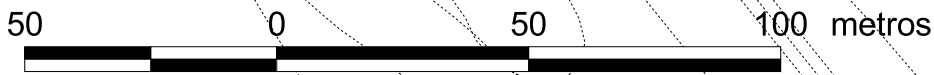
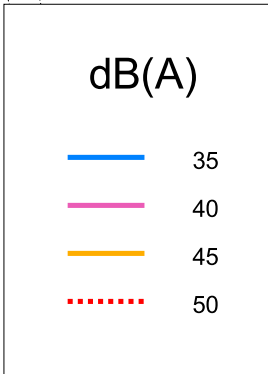

Escala 1:1.500
 Coordenada UTM 30 N
 Elipsoide Hayford

415800

415900

416000

416100

416200

416300

415800

415900

416000

416100

416200

416300

UE G10.1
Collado Villalba
Estudio acustico
Mapa 12 - Situacion 2011/dia
- 10 m -

4497600

4497500

4497400

4497300

4497600

4497500

4497400

4497300

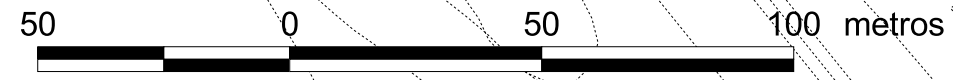
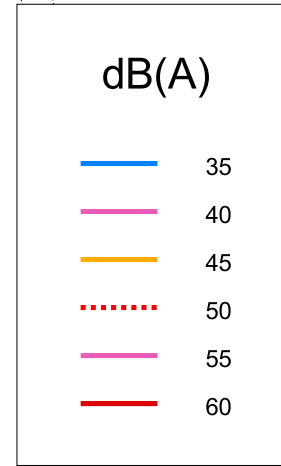

Escala 1:1.500
 Coordenada UTM 30 N
 Elipsoide Hayford

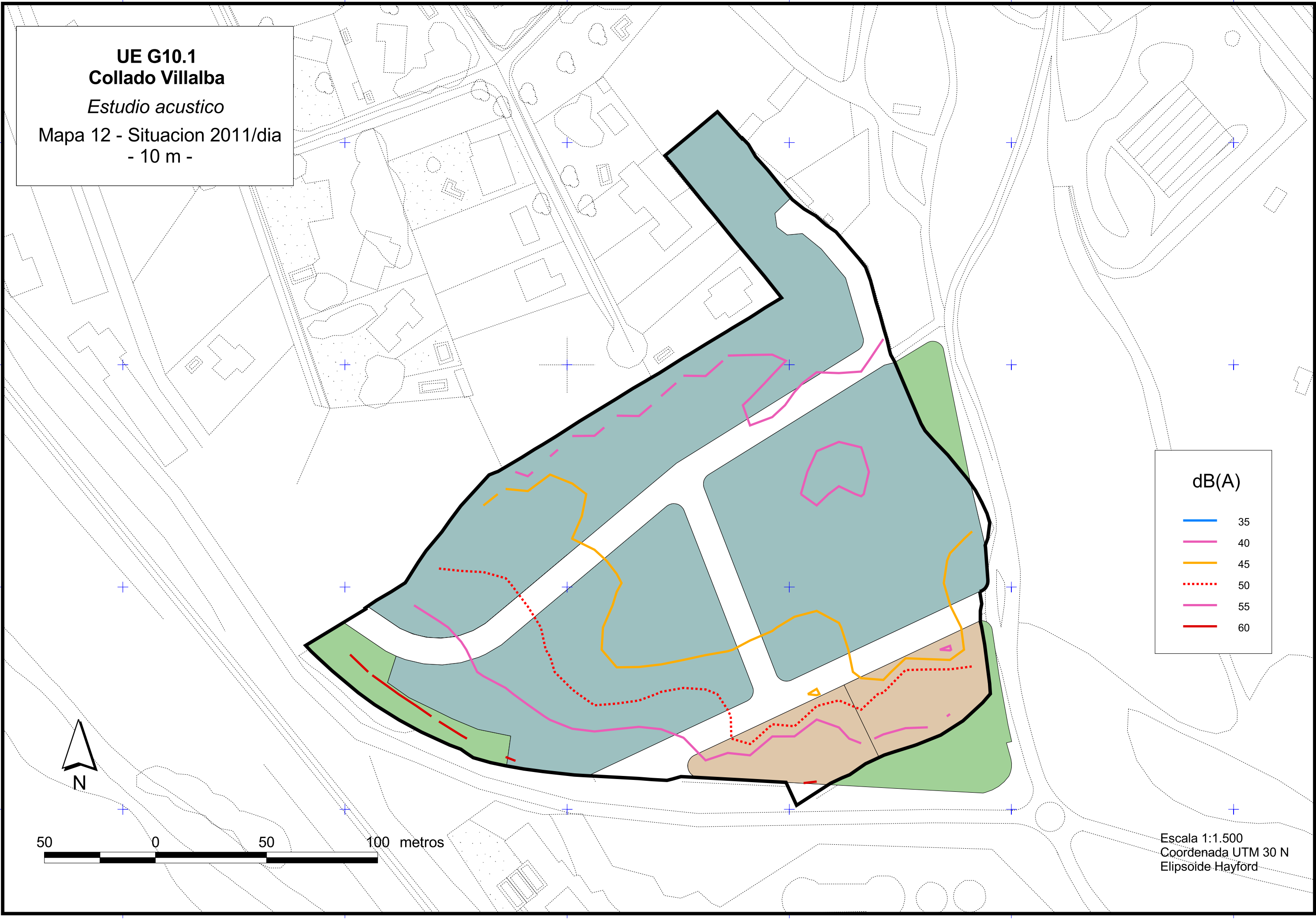

415800

415900

416000

416100

416200

416300

UE G10.1
Collado Villalba
Estudio acustico
 Mapa 13 - Situacion 2011/noche
 - 10 m -

4497600

4497500

4497400

4497300

4497600

4497500

4497400

4497300

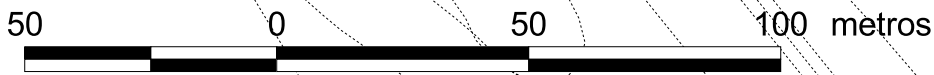
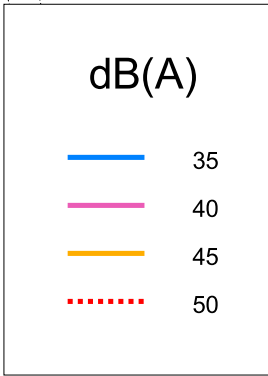

Escala 1:1.500
 Coordenada UTM 30 N
 Elipsoide Hayford

415800

415900

416000

416100

416200

416300